

# The Skipper **XS** suction pad holder/receiver

## Handle

Opens out fully to release suction cup.



## Holds XS unit

Simply clip in the XS unit.

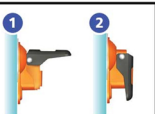

With the handle fully open, press firmly to glass or a high gloss surface and then close the handle until it clicks into place

## Lip

Pull from here to safely and easily remove from surfaces after use.

## Suction cup

Creates a vacuum to secure in place.



## Receives tape end

Clip in the tape end clip.



To remove, fully open the handle and pull away from the surface by peeling from the lip

**IMPORTANT NOTICE:** Always fully open the handle and pull from the lip to remove safely. Do not attach to painted walls as this could cause damage